

4T Four Post Large Model Hoist

The Tecalemit 4 tonne four post electro/hydraulic hoists come in three variants. The standard base model, large and wheel alignment specific models provide you with the options best suited for your workshop.

The TEG440 and TEG440L share the same core features. The TEG440W is supplied with front turning plate locations and rear slip plates with extra-long platforms suited for wheel alignment duties.



Four Post
Hoist



Lift Time



Lifting
Capacity



TECG440L

tecalemmit.com.au



TECALEMIT
lubrication and workshop equipment

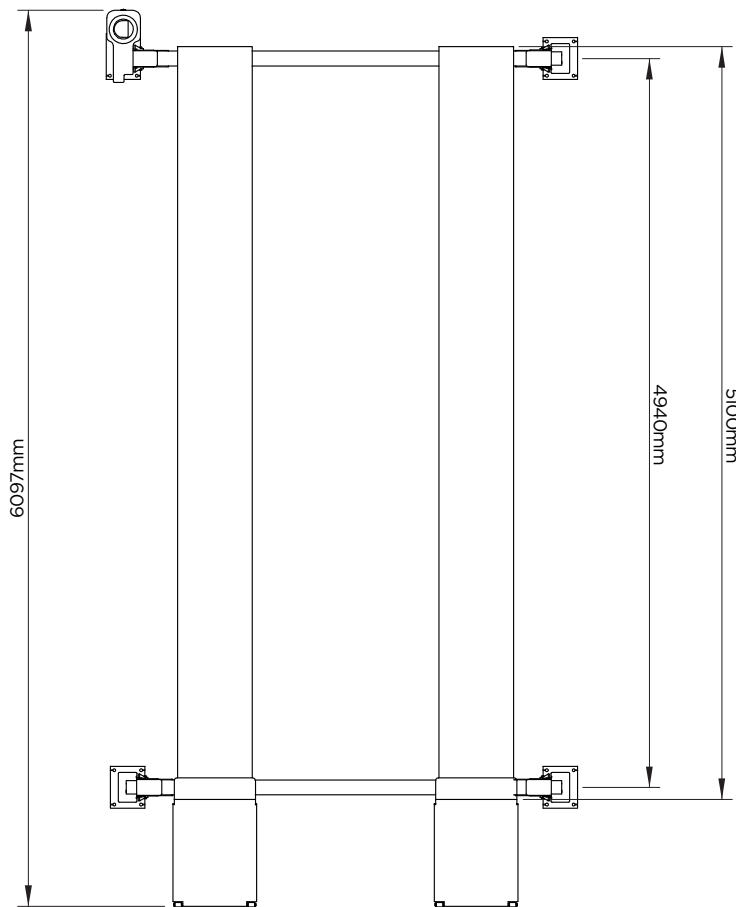
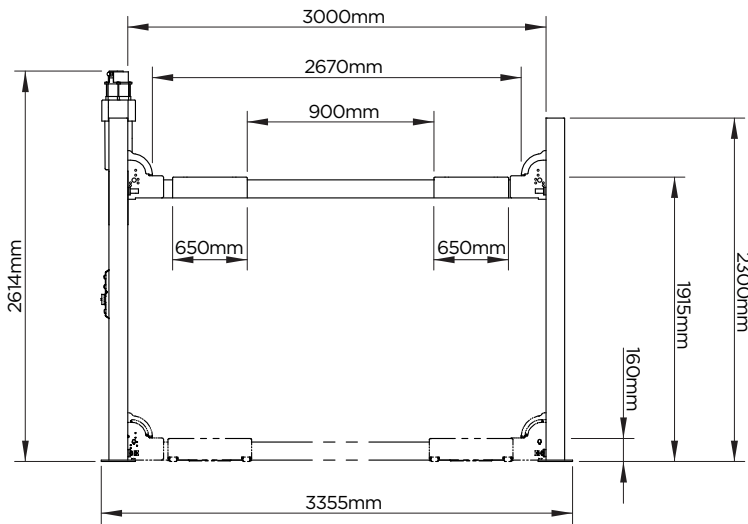

For complete dimensions and installation procedure please refer to the product manual.

Vehicle Hoist Features

- Hydraulic cylinder located inside the fixed platform.
- High-resistant, galvanised and pre-stretched metal cables with large-diameter pulleys and self-lubricating, maintenance-free bushes.
- Automatic mechanical back-up safety devices (every 100mm) with pneumatic release allowing stationary operation with unladen cables and immediate-triggering safety stud devices in case a cable slackens or fails.
- Automatic anti-toe trap alarm during final stages of lift descent.
- Mechanical, electrical & hydraulic safety devices along with low-voltage (24V) electrical system with control circuit.

Hoist Specifications

| | |
|-------------------------|---|
| Lifting Capacity | 4000kg |
| Maximum Lift Height | 1915mm |
| Lowered Platform Height | 160mm |
| Overall Dimensions | 6097mm long, 3355mm wide, 2614mm high |
| Inside Column Width | 3000mm |
| Width Between Platforms | 900mm fixed |
| Platform Width | 600mm |
| Power | 400V 50Hz 2.6kw |
| Lift Time | 35 seconds |

Spare Parts Support

Tecalemit stock a comprehensive supply of spare parts for all our hoists to ensure minimal downtime. With experienced staff on-hand to offer technical advice on all aspects, from hoist selection, installation, operation and on-going service and maintenance.